

1300 E. International Spdwy. Blvd.  
DeLand, FL 32724  
386-738-2224

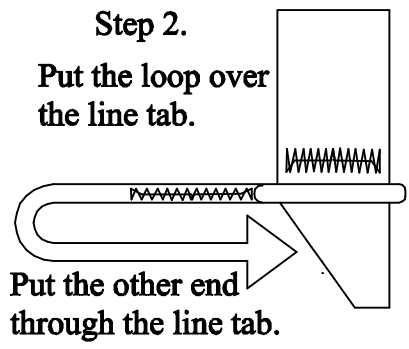

## P.D. Powered Parachute Field Replacement Lines

Step 1. Carefully cut the old **LINE** at the line tab.

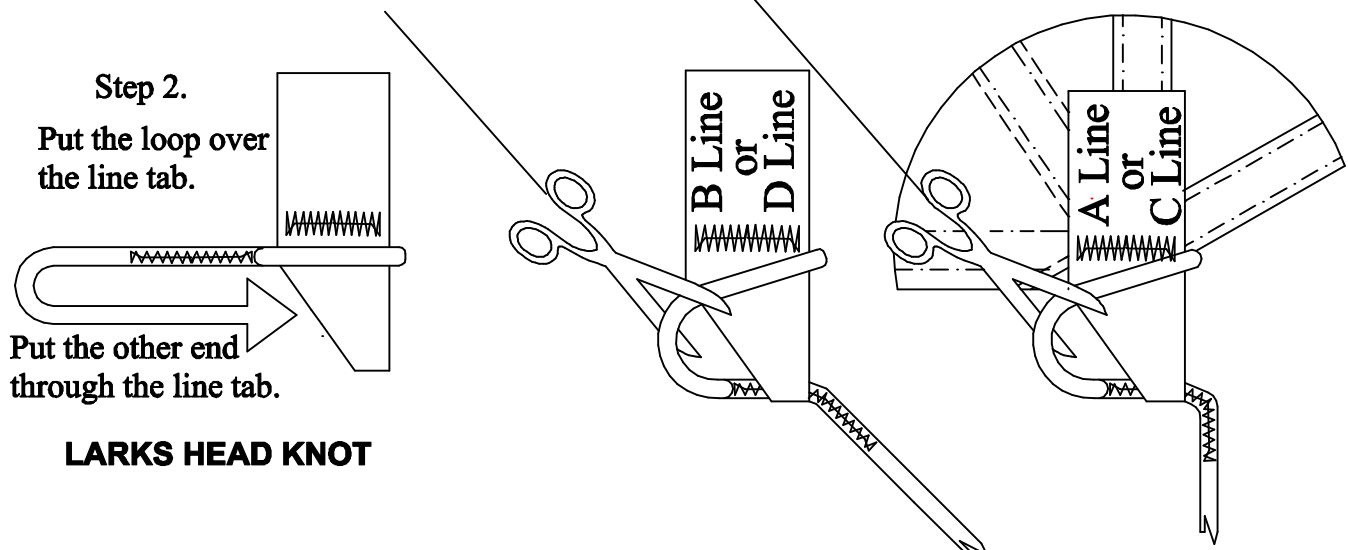

### LARKS HEAD KNOT

Step 2. Larks head the appropriate new lines to the correct line tabs.

Step 3. Place the lower ends of the two upper lines together.  
Larks head the new lower line to the upper lines.

Step 4. Place the lower end of the lower line on the link.

Step 5. Repeat steps 1 through 4 on the line that mirrors the new line to insure straight flight.

Step 6. Insure that the lines are in the proper location and compare them from side to side to assure they are the same length.

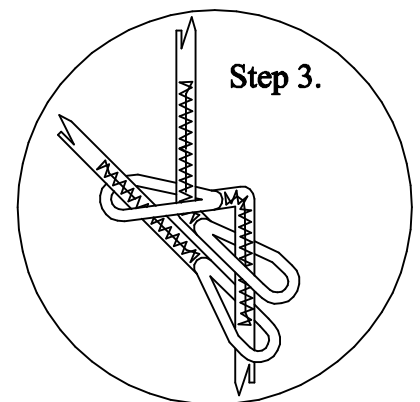

# IMPORTANT!

IT IS NECESSARY TO TAXI YOUR MACHINE WITH THE WING UP AFTER REPLACING LINES PRIOR TO FLIGHT. THIS IS TO INSURE PROPER RIGGING.

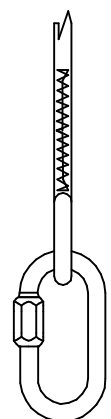

Step 4.